

### Adjustable Clutch Instructions for Eagle Driver (Models 1102, 1115, 1109)

1. Disconnect tool from air supply.
2. Remove Clutch housing from front of tool (this is reverse-threaded).
3. Remove Retaining Ring (1) and Spacer (2) from front of tool.
4. Remove Spring (3), Ball Retainer Ring (4) and Steel Ball (5) from front of Clutch. (DO NOT lose steel ball.)

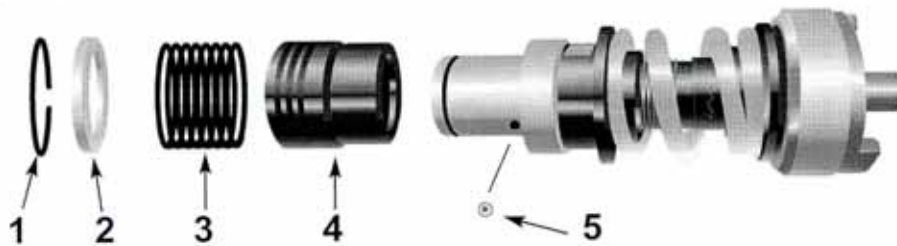

5. Place 1/4" Hex Key in front of Clutch Mechanism. (A)
6. Place Spanner over flat spots on Adjustment Nut (B) to hold unit for adjustments.
7. Rotate the Hex Key counter clock-wise to increase the torque output and clock-wise to decrease the torque output.

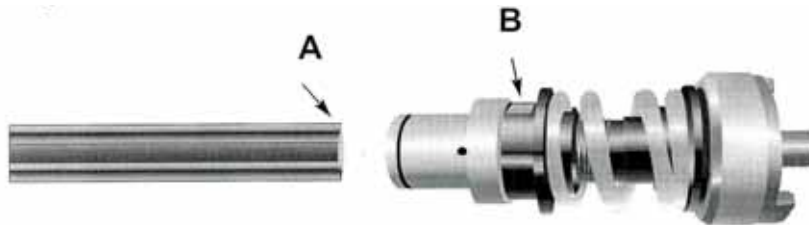

8. Assemble in reverse order of Steps #3, 2, 1.
9. Reattach air supply to tool and test tool.

**If you have any further questions, please contact our technical service:**

**Phone: 877-273-3903**

**Fax: 800-959-6601**

**10000 SE Pine Street, Portland, OR 97216**